

**Tobler**<sup>®</sup>  
Scaffolding. Formwork.



**MATON**

Temporary roofing systems.  
Swiss technology

**Temporary roofing systems – perfect protection from the elements.**



### **A system for every application**

MATO N temporary roofs can be used wherever the effects of wind and weather are unwanted. They protect buildings, monuments, bridges and motorways during the construction phase and restoration, and after fires. They provide effective protection from the weather at exhibitions, trade fairs and events and are available as movable structures.

### **The most cost-effective solution of all.**

You can twist and turn as you will: there is no more better alternative than a MATO N temporary roof with PVC sheeting. The purchase price is about half that of a metal cassette roof and the outlay for assembly and dismantling is between 30% and 60% less, thanks to the lightweight construction and simple handling.

### **Spans up to 38 m**

MATO N can be designed as a single- or double-pitch roof, depending upon the application. Spans of up to 38 m are possible, depending upon design and beam strength.

MATO N temporary roofs can even be assembled manually, very simply and quickly, thanks to their lightweight aluminium structure. They can also be mounted on any type of scaffolding.

# **A range of services which leaves no prayer unans- wered.**

We want to provide you with outstanding scaffolding systems and faultless, comprehensive service. We believe that customer satisfaction means much more than just the correct, punctual execution of your order. We aim to be your competent partner for all questions and services to do with professional scaffolding.

## **Research and development**

We are prepared to reinvent the wheel every day in order to stay successful. Standing still means going backwards. This applies to our industry too. For this reason we put a lot of time, money and effort into research into new technologies and the further development of existing systems. Our solutions are intended to guarantee the greatest possible benefit and the highest possible level of safety for you, not just today, but in the future as well.

## **Customer-specific solutions**

Another of our strengths is the development of customer-specific solutions. Qualified designers, engineers and draughtsmen are happy to work out individual solutions in close cooperation with you.

## **Comprehensive restoration and repair service**

We have many years' experience of restoration and repair of commercially-available scaffolding systems. Various factors determine whether it is worth repairing faulty scaffolding. Talk to us first!

## **Old for new**

Is your old scaffolding making your labour costs too high – Is your scaffolding no longer making a profit? We have the right solution, whether a change of system or modernisation of your existing scaffolding system.

## **Finance**

We and our banking partner shall be happy to make individual, practical suggestions.



# Contents

from A to Z



## Table of contents

<b>F</b> all arrester, steel	Page 14
<b>S</b> heet clamp	Page 10
Elbow	Page 10
<b>R</b> oof support frame	Page 12
Roof support frame, adjustable	Page 12
Gutter	Page 12
<b>F</b> eed rollers for temporary roof sheet	Page 16
<b>M</b> ovable temporary roof	Page 18
Ridge capping	Page 11
Ridge beam	Page 11
<b>R</b> ail, aluminium	Page 13
<b>C</b> atwalk bracket for temporary roof	Page 12
Catwalk roof	Page 15
<b>F</b> oam rubber gasket	Page 10
<b>T</b> emporary roof anchor, steel	Page 15
Temporary roof beams	Page 9
Temporary roof sheets	Page 14
Grooved tube	Page 16
<b>B</b> race	Page 13
Brace, aluminium	Page 13
<b>C</b> onnecting tube	Page 10
<b>W</b> all beams	Page 9
Wall retainer	Page 10
<b>T</b> ie bars	Page 11





## Temporary roof beams

- Aluminium beams with an overall height of 45 cm
- Tube Ø 48.3 mm
- 8 per bundle

Wall thickness in mm	Length in cm	Height in cm	Weight in kg	Order no.
4	160	45	10	N-560160
4	310	45	17	N-560310
4	410	45	20.7	*N-560410
4	510	45	27	N-560510
4	610	45	30.5	N-560610
4	710	45	36	*N-560710
4	810	45	41	N-560810

\* Not held in stock

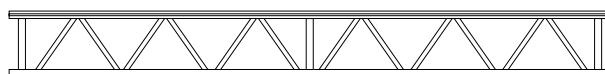

- Aluminium beams with an overall height of 85 cm for spans up to 38 m
- Observe our instructions for assembly and use

Wall thickness in mm	Length in cm	Height in cm	Weight in kg	Order no.
4	160	85	14.2	N-561160
4	310	85	27.9	N-561310
4	410	85	37.5	*N-561410
4	510	85	40.3	N-561510
4	610	85	50.2	N-561610
4	710	85	57	*N-561710
4	810	85	62.7	N-561810

\* Not held in stock

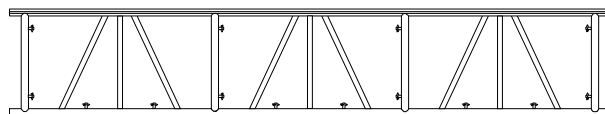

## Wall beams

- In aluminium
- For MATO 8 walers
- 8 per bundle
- Ideal for moveable temporary roofs and roofs for events

Wall thickness in mm	Length in cm	Width in cm	Weight in kg	Order no.
4	310	20	22	N-8-563300

- Wall beam extension
- 8 per bundle

Wall thickness in mm	Length in cm	Width in cm	Weight in kg	Order no.
4	100	20	7	N-8-563100
4	200	20	12	N-8-563200

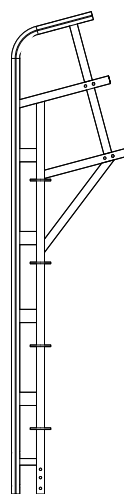

N-8-563300



N-8-563100



N-8-563200

## Wall retainer

- Temporary roof wall retainer

Length in cm	Width in cm	Weight in kg	Order no.
70	8	4.5	N-588045

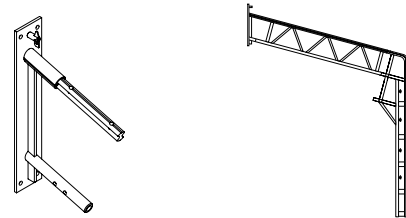

## Elbow

- Grandstand end
- Beam end for 45cm temporary roof beam

Length in cm	Width in cm	Weight in kg	Order no.
100	120	8	N-588010
70	50	4	N-588020

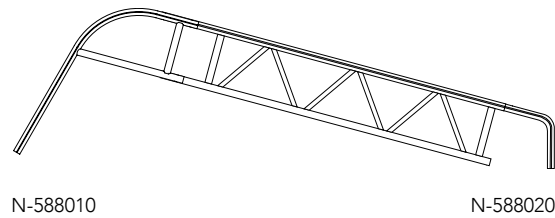

- Beam end for 85cm temporary roof beam

Length in cm	Width in cm	Weight in kg	Order no.
120	30	1.4	N-588021

## Connecting tube

- For round tube
- Steel

Length in cm	Weight in kg	Order no.
50	3	N-560050

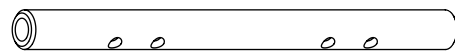

- For grooved tube
- Aluminium

Length in cm	Weight in kg	Order no.
60	1.3	N-560060

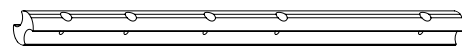

## Sheet clamp

- Sheet clamp inc. 12 x 60 aluminium pins and spring cotter

Length in cm	Weight in kg	Order no.
300	2	N-588040

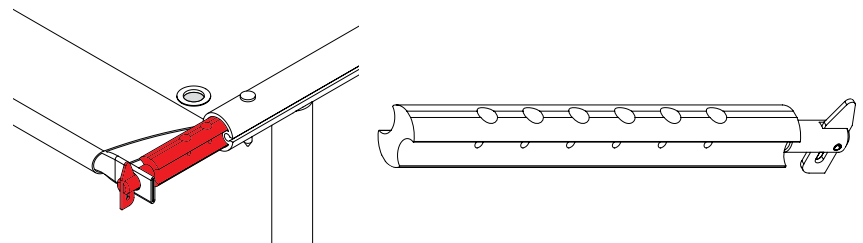

## Foam rubber gasket

- Foam rubber gasket for grooved tube

Weight in kg	Order no.
0.1	N-850002

- Foam rubber gasket for pins

Weight in kg	Order no.
0.05	N-850003



## Ridge beam

- In aluminium

Length in cm	Height in cm	Weight in kg	Order no.
100	45	7	N-560100
110	85	10.5	N-561110

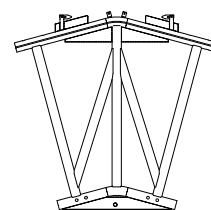

Bore for tie bar and pins

## Ridge capping

- In aluminium, textured, accessible on foot only with fall arresters fitted all round

Length in cm	Width in cm	Weight in kg	Order no.
240	80	13	N-566250

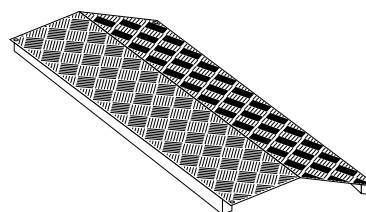

## Tie bars

- Ridge tie bar, inc. connectors

Length in cm	Weight in kg	Order no.
800	24.5	N-564800

- Soffit tie bar

Length in cm	Weight in kg	Order no.
300 x 800	48	*N-565010
300 x 700	54	*N-565014
400 x 800	60	*N-565018
500 x 760	66	*N-565022

\* Not held in stock

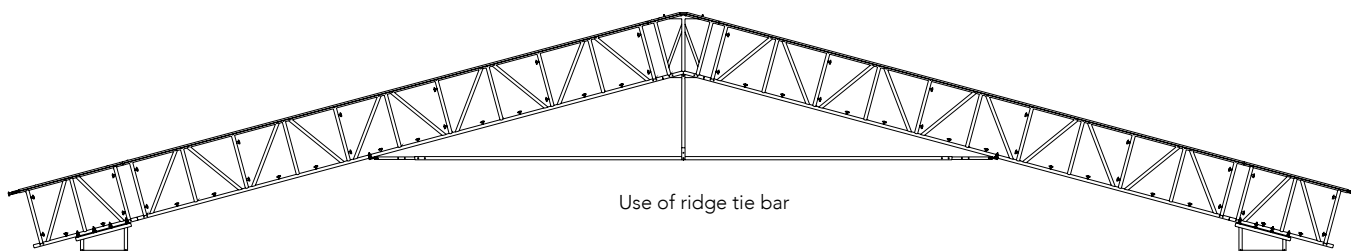
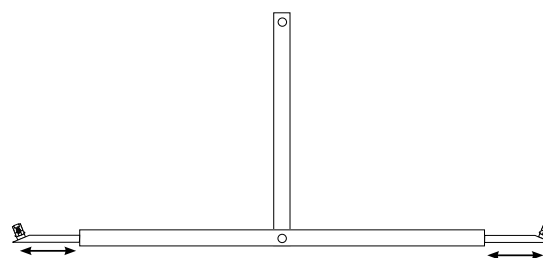

Use of ridge tie bar



## Roof support frame

- In steel

Width in cm	Weight in kg	Order no.
65	12.8	N-2-570065
70	11.2	N-1-570070
100	15.7	*N-1-570100

\* Not held in stock

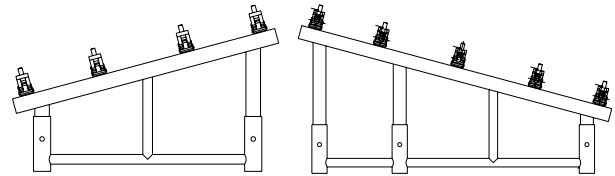

## Roof support frame, adjustable

- Compatible with MATO 8
- Adjustable from 0° to 15°

Width in cm	Weight in kg	Order no.
75/110	16.3	N-571110

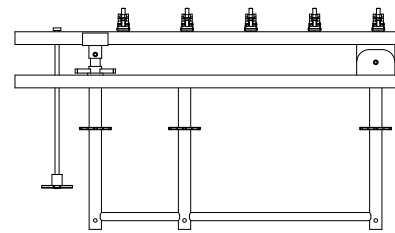

## Gutter

- In steel

Length in cm	Width in cm	Weight in kg	Order no.
270	15	19.6	*N-588260
270	15	20.3	*N-588265
270	15	27.8	*N-588270

\* Not held in stock

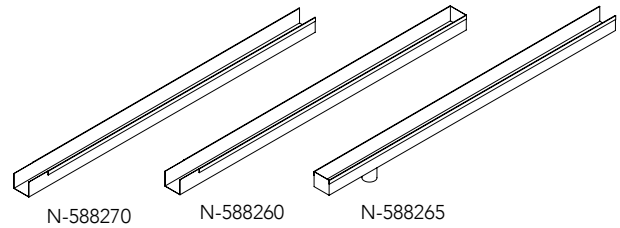

- Gutter bracket

Weight in kg	Order no.
2.4	*N-589010

## Catwalk bracket for temporary roof

- For fitting to an 85 cm roof beam
- The slope of 15° makes the bracket accessible horizontally

Width in cm	Weight in kg	Order no.
110	21.2	N-254110

- Aluminium guard rail posts for catwalk bracket

Height in cm	Weight in kg	Order no.
200	4	1-222200

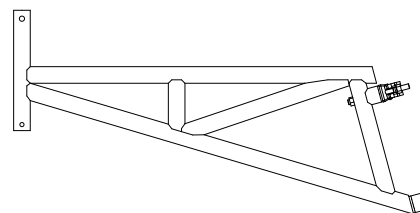
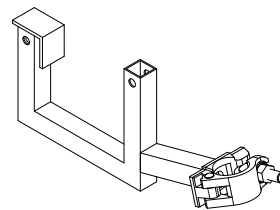

## Brace

- Horizontal with screw mount
- In galvanised steel tube
- Tube Ø 48.3 mm
- 50 per bundle

Length in cm	Weight in kg	Order no.
150	7	N-574150
200	8.5	N-574200
250	10.3	N-574250
300	11.7	N-574300

- Diagonal with screw connector
- Colour coding

Length in cm	Width in cm	Weight in kg	Order no.
• 250	250	11	N-575250
• 300	250	11.5	N-575300
• 200	250	10.1	N-576200
• 200	70	7.3	N-577070
• 200	100	7.6	N-577100

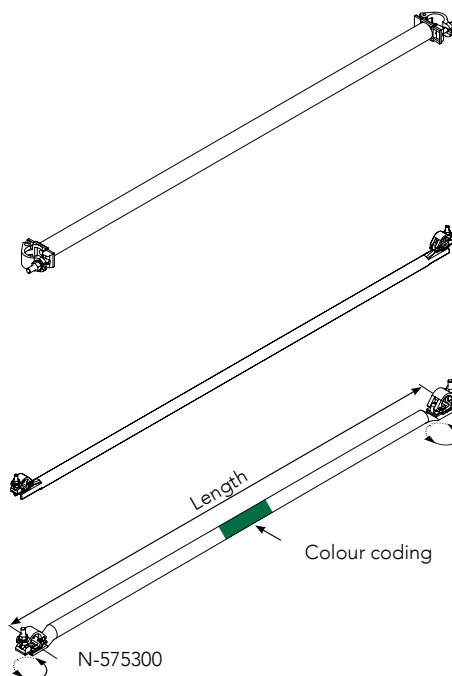

## Rail, aluminium

- For 85 cm high roof temporary beams (see page 9)
- With diagonal struts. See MATO 1, p. 12 for other lengths.
- 25 per bundle, 40 per rack

Length in cm	Width in cm	Weight in kg	Order no.
250	60	7	1-130250
300	60	8.7	1-130300

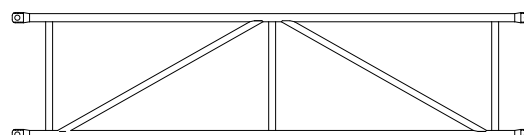

## Brace, aluminium

- Tube Ø 40 mm x 2.50 mm
- For stretching and fixing the sheet (sheet clamp: N-588040, page 10)
- 100 per bundle

Length in cm	Weight in kg	Order no.
65	0.6	60-131065
70	0.7	60-131070
100	1	60-131100
150	1.5	60-131150
200	2	60-131200
250	2.5	60-131250
300	3	60-131300

- With side pressure system
- For fitting below the ridge capping

Width in cm	Weight in kg	Order no.
250	8.1	N-131250
300	9.8	N-131300

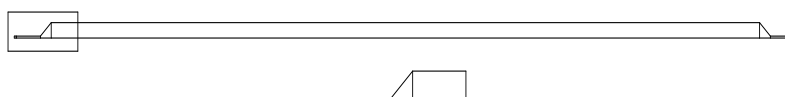
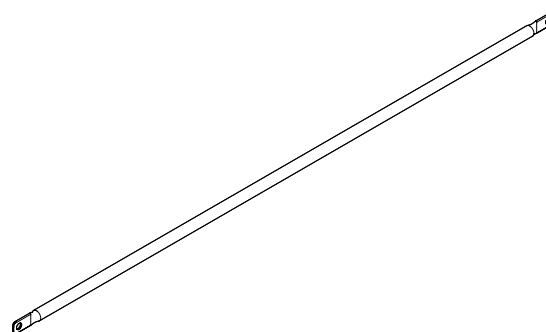

## Temporary roof sheets

- With cord, 650 g/m<sup>2</sup>
- Colour coding

Length in cm	Width in cm	Weight in kg	Order no.
• 580	247	10	*N-580010
• 680	247	11	*N-580014
• 880	247	15	N-580018
• 1190	247	20	N-580022
• 1360	247	22	N-580026
• 1760	247	29	N-580030
• 1960	247	32	N-580034
• 2180	247	35	*N-580038

\* Not held in stock

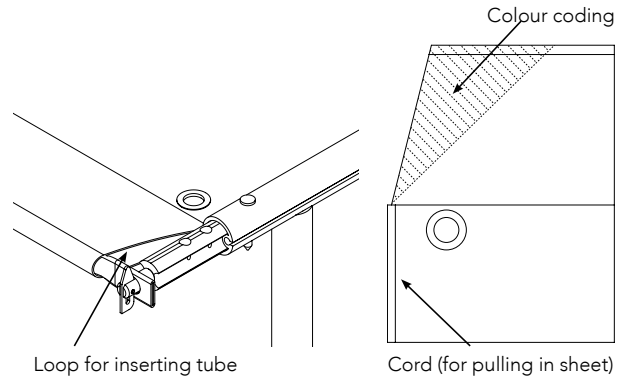

- Special sizes

Order no.
*N-580001

\* Not held in stock

- For gable sheets
- With cord and eyelets
- 650 g/m<sup>2</sup>

Length in cm	Width in cm	Weight in kg	Order no.
360	100	4	*N-584010
460	100	5	*N-584014
560	100	7	*N-584018
660	100	8	*N-584022
860	100	12	*N-584026
1170	100	20	*N-584030

\* Not held in stock

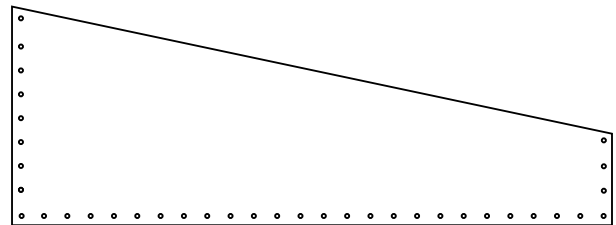

- Special measurements

Order no.
*N-584001

\* Not held in stock

## Fall arrester, steel

- Central safety posts for 40 cm and 85 cm temporary roof beams

Length in cm	Weight in kg	Order no.
120	16.2	N-585040

- Edge safety posts for 40 cm and 85 cm temporary roof beams

Length in cm	Weight in kg	Order no.
120	10.2	N-585050

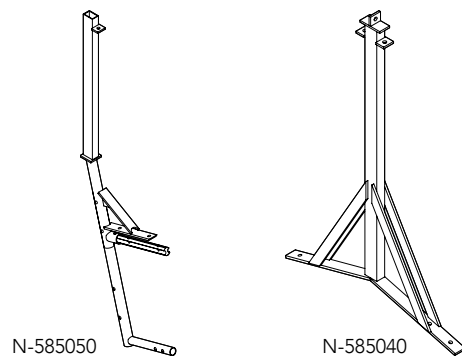

## Temporary roof anchor, steel

- Also suitable as a scaffolding anchor for special structures
- Baseplate
- Galvanised

Length in cm	Width in cm	Weight in kg	Order no.
60	30	17.8	N-585100

- Peg, galvanised steel for temporary roof anchor

Length in cm	Weight in kg	Order no.
80	6.2	N-585101

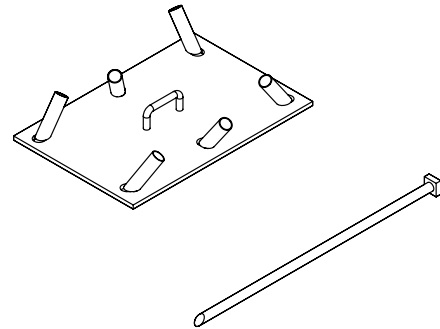

## Catwalk roof

- Adjustable
- Water drainage possible to the inside or outside
- To fit any façade scaffolding, width dependent upon system
- The only stormproof catwalk roof

Length in cm	Weight in kg	Set for	Order no.
210	8	MATO 1	N-1-586225
210	8	MATO 2	N-2-586225

Set consisting of vertical poles (large and small), aluminium rail and clip

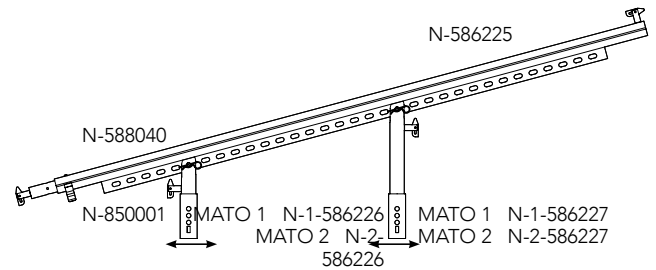

- Sheet for catwalk roof, with cord
- Colour coding

Length in cm	Width in cm	Weight in kg	Order no.
• 70	225	1.2	*N-587070
• 100	225	1.5	*N-587100
• 150	225	2	N-587150
• 200	225	3	N-587200
• 250	225	3.5	N-587250
• 300	225	4	N-587300

\* Not held in stock

- Sheet clamp inc. 12 x 60 aluminium pins and spring cotter

Width in cm	Weight in kg	Order no.
300	2	N-588040

- Catwalk roof clip

Weight in kg	Order no.
0.1	N-850001

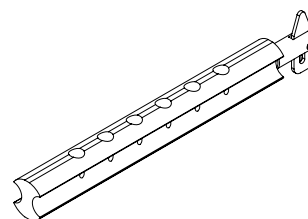
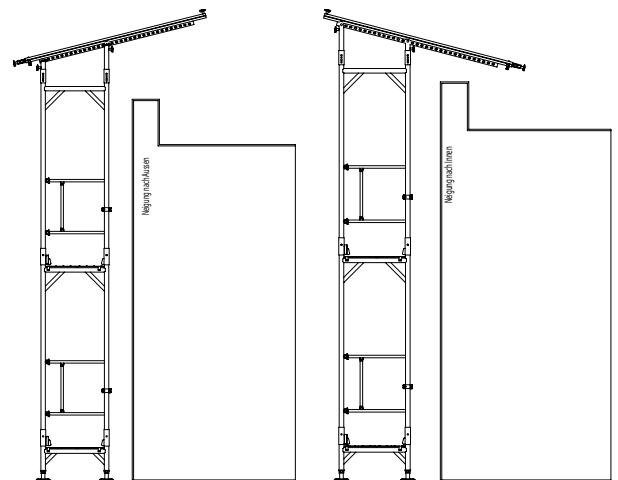

N-588040

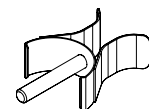

N-850001

## Feed rollers for temporary roof sheets

- For feeding temporary roof sheets

Weight in kg	Order no.
2	N-850004



## Grooved tube

- Grooved tube in aluminium

Length in cm	Weight in kg	Order no.
50	1.2	N-190050
100	2.4	N-190100
200	4.8	N-190200
300	7.2	N-190300
400	9.6	N-190400
500	12	N-190500
600	14.4	N-190600
700	16.8	N-190700
800	19.2	N-190800

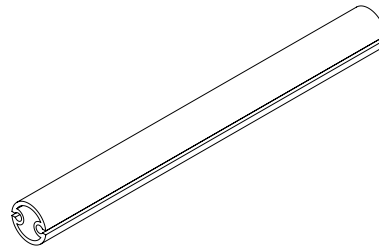

- Grooved tube in aluminium with half connector

Length in cm	Weight in kg	Order no.
100	3.1	*N-192100
200	6.2	*N-192200
300	9.3	*N-192300
400	11.7	*N-192400
500	14.8	*N-192500
600	18.6	*N-192600

\* Not held in stock

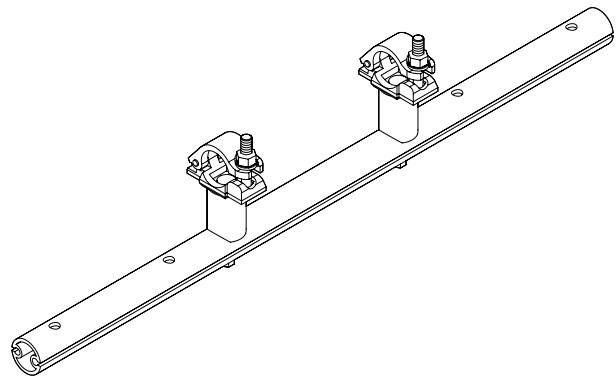

- Grooved tube in aluminium with connecting tube for extending the end of a beam

Length in cm	Weight in kg	Order no.
50	2.4	N-191050

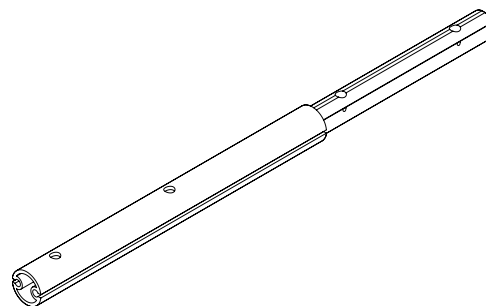



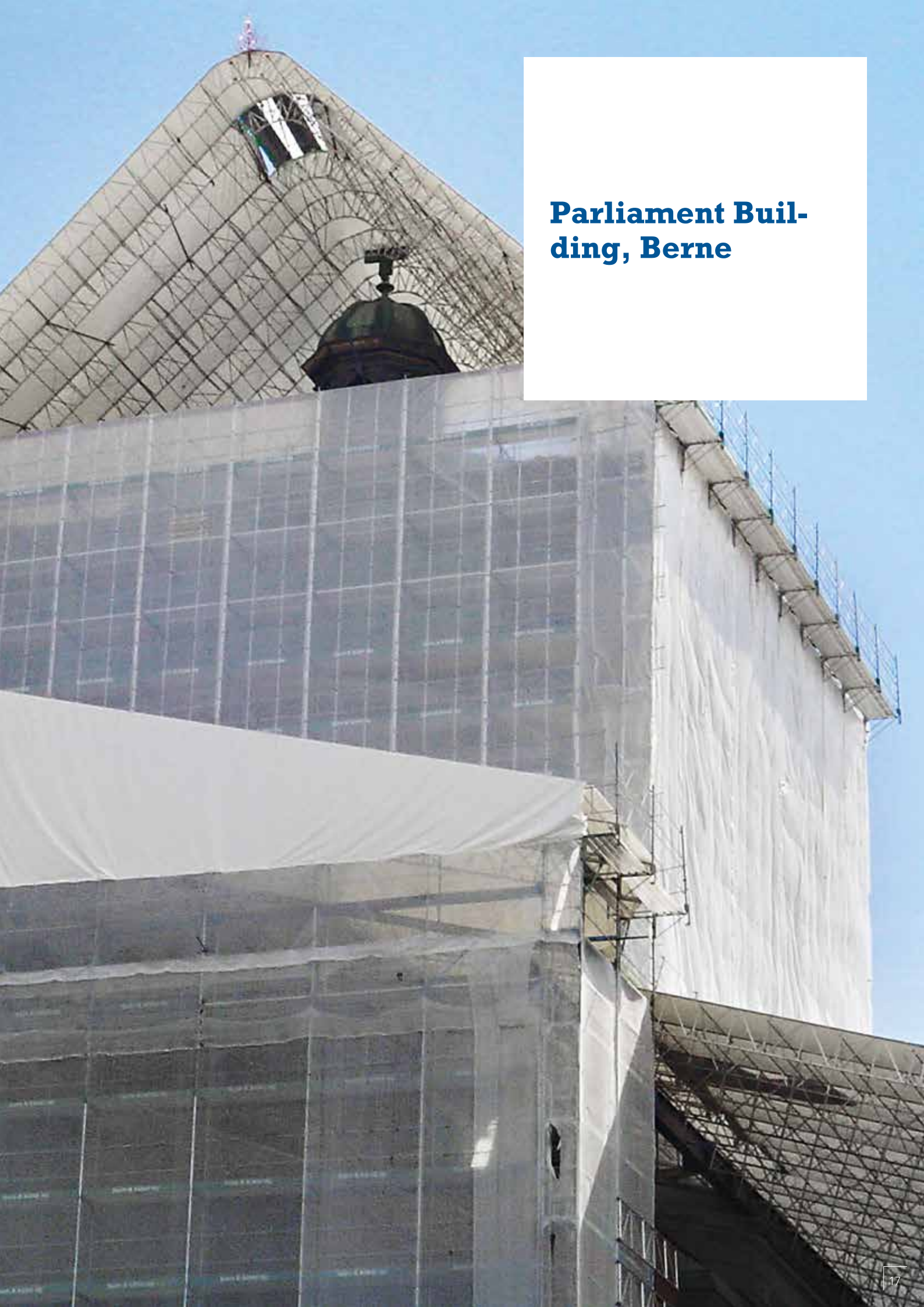

## **Parliament Building, Berne**



## Moveable temporary roof

- 70 cm push-fit frame for moveable temporary roof

Weight in kg	Order no.
12.5	N-579070

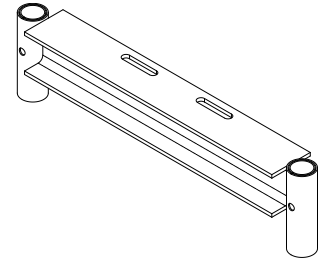

- Bracket for attaching IPE beams to push-fit frame

Weight in kg	Order no.
0.5	N-579071

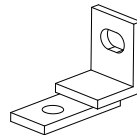

- IPE 100 running rail with fishplate

Length in cm	Weight in kg	Order no.
250	28	N-579250

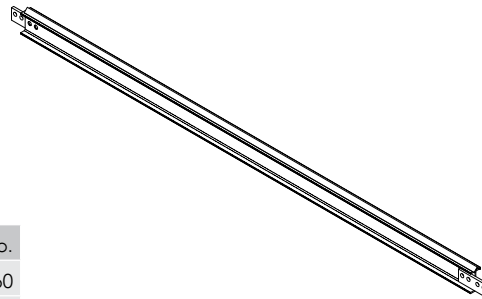

- IPE 100 rail with outside brackets

	Length in cm	Weight in kg	Order no.
right	260	31	N-580260
left	260	31	N-581260



- Heavy roller with internal steel wheel for running rail, with brake

Weight in kg	Order no.
8.35	N-579020



- Roller guard

Weight in kg	Order no.
0.4	N-579021

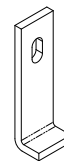

- Roller / beam connector

Weight in kg	Order no.
11.5	N-579080

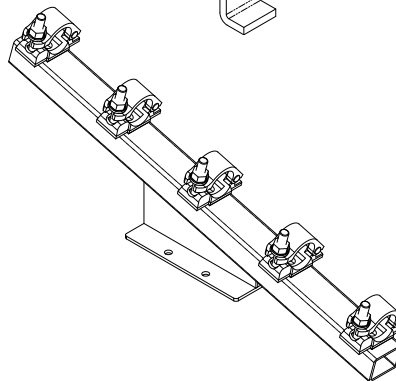

## Moveable temporary roof

- Grooved tube with half connector

Length in cm	Weight in kg	Order no.
310	10	N-579310
410	13	N-579410
510	16	N-579510
610	19	N-579610
710	22	N-579710
810	25	N-579810



- Protective T-frame for temporary roof

Weight in kg	Order no.
2.7	N-579258

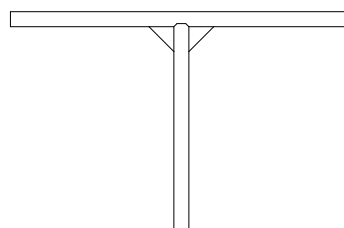

- Elbow

Weight in kg	Order no.
4.5	N-579259

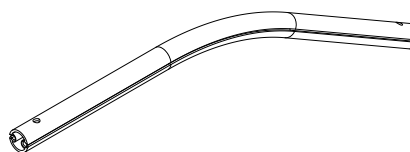

- Ridge elbow

Weight in kg	Order no.
2.8	N-579260

- Ridge connector

Weight in kg	Order no.
0.4	N-579261

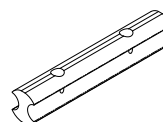

**In the dry safely  
and quickly with  
MATO N**





## Zurich Kloten

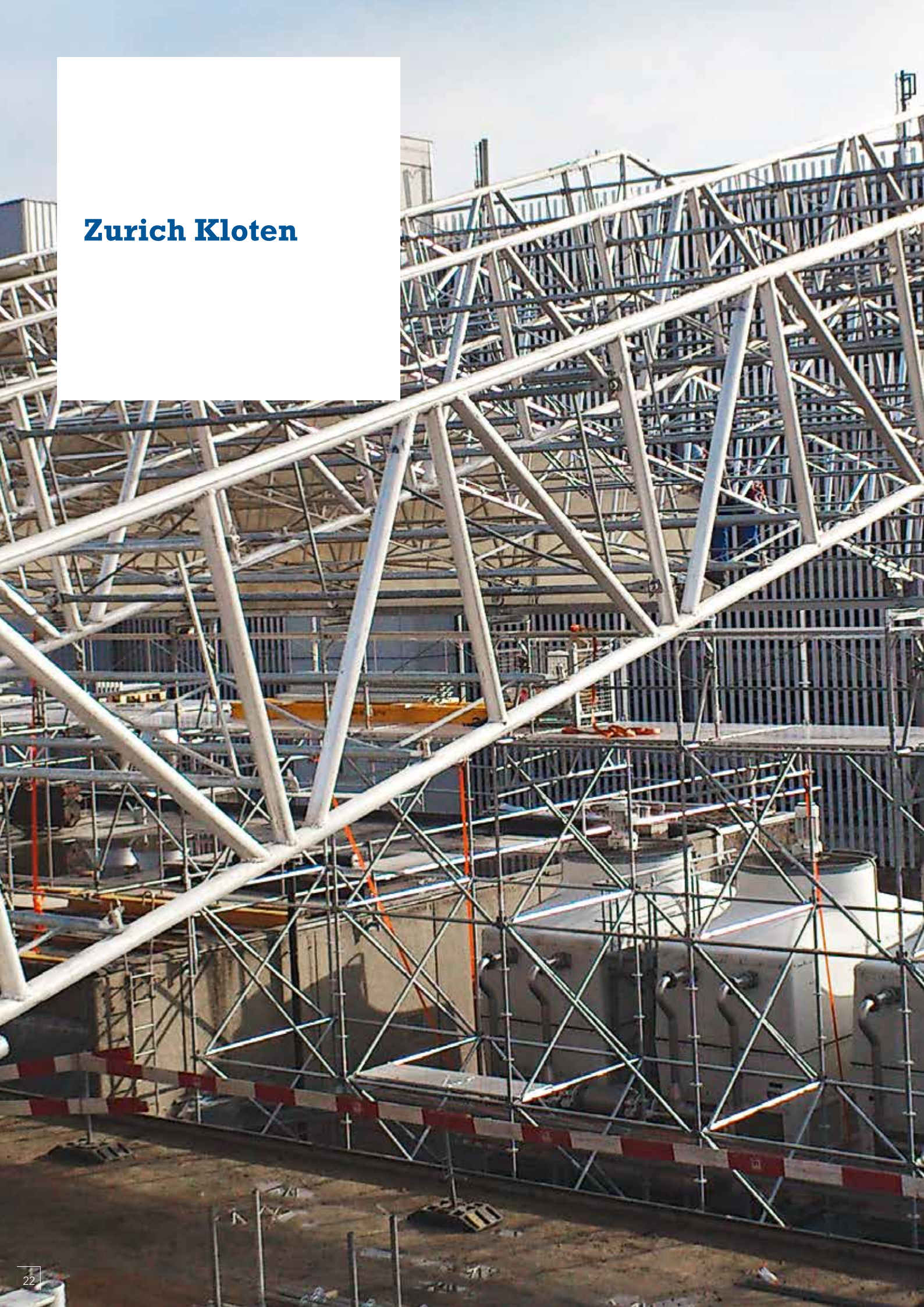

# General Terms and Conditions of Business (T&Cs) as at 1 January 2013

**These T&Cs govern legal relationships between Tobler AG (hereinafter referred to as TOBLER) and its contracting partners (hereinafter referred to as Client) arising from the sale, rental and assembly of scaffolding, formwork and the corresponding accessories. They constitute a framework contract applicable to the conclusion of all contracts and are binding until revoked.**

## 1. Tender and conclusion of the contract

- 1.1. Tenders, goods and services will be provided by TOBLER solely on the basis of these T&Cs, which will be deemed to have been accepted when the goods or services are ordered. The T&Cs will also expressly apply to all future orders by the Client.
- 1.2. A contract will be concluded when TOBLER accepts a written, telephone or personal order unconditionally.
- 1.3. Verbal assurances by TOBLER will only be valid if confirmed in writing and signed.
- 1.4. TOBLER will only be bound by the Client's general terms and conditions of business if they correspond to its own or if it has agreed to them in writing. Divergent conditions of the Client which TOBLER has not expressly recognised in writing will not be binding upon it.

## 2. Technical documents

- 2.1. Prospectuses, catalogues, etc. will not be binding in the absence of any agreement to the contrary. Details in technical documents will only be binding if they are expressly guaranteed in writing.
- 2.2. The right to make technical modifications is reserved. Differences from the prospectus or from details in other sales documents or from earlier deliveries in terms of configuration, weights and measurements of the goods will only be relevant if the intended purpose of the goods is restricted to a significant extent.
- 2.3. The final potential configuration is expressly reserved, particularly in the case of new designs or special configurations.
- 2.4. TOBLER will be entitled to supply equivalent unbranded parts from subcontractors.

## 3. Terms of payment

- 3.1. In the absence of any agreement to the contrary, payment must be made to TOBLER within thirty days, strictly net. The Client will be entitled to deduct a prompt payment discount of 2% for payment within ten days of the date of the invoice. Further deductions will only be admissible if expressly agreed in writing. Unjustified deductions will be charged retrospectively.
- 3.2. In the case of arrears, the Client will be liable for 7% p.a. interest on arrears with effect from the due date of payment, without a reminder from TOBLER.
- 3.3. The absence of minor parts from the order or the assertion of claims under guarantee against TOBLER will not entitle the Client to delay payments due.
- 3.4. Payment of the entire purchase price or the balance thereof will be due immediately if acceptance is delayed by the Client. The Client must bear the cost of any demurrage by the transport contractor.
- 3.5. Should the deposit not be paid or the requisite security not be provided in accordance with the contract, TOBLER will be entitled to uphold or cancel the contract and demand compensation in either case.

## 4. Delivery terms

- 4.1. In the absence of any agreement to the contrary, the place of fulfilment will be TOBLER's registered office in Rheineck.
- 4.2. Despatch and carriage are for the account and at the risk of the Client. The Client will be responsible for insurance against loss of any type whatsoever. The Client must bear any customs duty payable.
- 4.3. Pallets and crates are only made available on loan. The Client must return them at its own expense, otherwise TOBLER will invoice their cost.
- 4.4. Delivery will be made at the time desired by the Client, as far as possible. Notified or agreed delivery periods and times will be observed as far as possible, but are not binding. Should delivery be delayed for reasons for which TOBLER is not responsible (force majeure, import or transport problems, delay by third-party suppliers, changes subsequently demanded by the Client, etc.), the delivery date will be postponed accordingly.
- 4.5. A failure to observe the delivery deadline will not entitle the Client to cancel the contract, delay acceptance or demand compensation for delay.
- 4.6. Should it be impossible to provide goods and services in the foreseeable future due to events over which TOBLER has no control, TOBLER will be entitled to cancel the contract by notifying the Client, without incurring liability for compensation.
- 4.7. If the Client has been informed that the goods ordered are ready for despatch or collection, it will be obliged to collect or arrange delivery of the goods within five working days of notification. The Client will be in arrears of acceptance after this deadline has expired. In the event of arrears of acceptance, the Client will be obliged to compensate TOBLER for losses thus incurred. In this case, TOBLER will be entitled to retain the delivery at the expense and risk of the Client, store it on its premises, charging an appropriate fee, or cancel the contract, with payment of compensation for the loss incurred by TOBLER. Delayed acceptance will be deemed to apply if the Client unjustifiably refuses to accept the consignment due to delays in delivery. Even if TOBLER retains the goods or stores it on its premises, it will be entitled to cancel the contract at any time, without notice and without setting a period of grace, and to demand repayment of the loss which it has incurred.

## 5. Transfer of risk

- 5.1. The risk applicable to the deliverable will be transferred to the Client when the consignment leaves TOBLER.

## 6. Complaints

- 6.1. The Client must inspect the goods and assembly work immediately after receipt and execution.
- 6.2. It must notify TOBLER of any shortcomings in writing within three days, otherwise the goods and services will be deemed to have been approved.

## 7. Guarantee under the purchase agreement

- 7.1. In the case of new products (with the exception of timber, spare parts, tarpaulins, nets, any plastic components, small parts such as screws, nuts, etc., and mountings such as cables and tarpaulin ties), TOBLER will issue a guarantee to the Client for six months with effect from despatch of the consignment from TOBLER, provided that examination and notification take place punctually in accordance with paragraph 6. Liability for particular product characteristics will only be accepted if guaranteed in writing by TOBLER. Differences attributable to production or material will not give rise to entitlement to a guarantee. Moreover, the guarantee will lapse if the Client or an authorised agent of the Client makes modifications or repairs to the goods without the written agreement of TOBLER.
- 7.2. Any guarantee whatsoever for used items is precluded. No guarantee will apply to installed parts from third-party suppliers or if installed parts from third-party suppliers cause a fault or damage, or inhibit operation.
- 7.3. The guarantee may be restricted to repair or replacement of the defective parts, at TOBLER'S discretion. Further claims under guarantee by the Client, particularly for redhibition, reduction or damages, are precluded.
- 7.4. Replaced parts are the property of TOBLER and must be returned to it.
- 7.5. Repair work or the supply of replacements will not extend or renew the period under paragraph 7.1. The guarantee period applicable to the original delivery will apply to the repaired or replaced parts.
- 7.6. TOBLER will be entitled to refuse to rectify defects for as long as the Client fails to fulfil its obligations to TOBLER, without restriction.

- 7.7. TOBLER rejects any guarantee for damage attributable to normal wear and tear, inappropriate or violent handling, excess stress, inappropriate use and maintenance of the items, the use of unsuitable materials, accidents or force majeure.
- 7.8. Only TOBLER may carry out repairs to scaffolding components. Otherwise any claim under guarantee will lapse.

## 8. Reservation of title under the purchase agreement

- 8.1. TOBLER will remain the proprietor of the item purchased until the purchase price, including interest and any other costs, has been paid in full. The Client is obliged to inform any tenant of premises on which it accommodates the item purchased of the reservation of title in writing, before storing it.
- 8.2. The Client authorises TOBLER to register retention of title with the responsible authority.
- 8.3. The Client may not sell, pledge, loan or rent the purchased item until full payment of the purchase price, including all interest and costs, has been made. The Client also undertakes not to remove the purchase item from Swiss territory without the express written agreement of TOBLER. The Client must disclose the reservation of title immediately in the case of pledging, retention or seizure, and inform TOBLER in writing whenever possible, before the corresponding measure is taken.
- 8.4. The Client is obliged to cooperate with measures necessary to protect TOBLER'S property, at its own expense.
- 8.5. The Client is obliged to insure the purchased item against all likely risks at its own expense to the benefit of TOBLER, throughout the term of retention of title. The Client must submit a corresponding certificate of insurance on demand. Should the Client fail to comply with this requirement, TOBLER will be entitled to subscribe to insurance for its own benefit, at the expense of the Client.

## 9. Provisions specific to rental

- 9.1. Rent will always be net of carriage to and from the place of use. The costs of carriage will be charged separately, if it is arranged by TOBLER.
- 9.2. The Client is obliged to notify any tenant on whose premises it accommodates the rented goods of TOBLER'S rights of ownership in writing, before placing it there.
- 9.3. The benefit and risk associated with the rented goods will be transferred to the Client no later than at the time at which it can dispose of said goods, i.e. either when the rented goods are transferred to the Client or a third party appointed by the latter at TOBLER'S warehouse or when the rented goods are unloaded on site, if the Client has commissioned TOBLER with carriage. If delivery to an unoccupied building site is ordered, TOBLER will not assume any guarantee for the integrity and completeness of the delivery.
- 9.4. The Client must treat the rented goods with care and maintain them properly. The Client will be invoiced and must pay for damage and excessive wear attributable to inappropriate use of the rented goods. Formwork must be used economically and carefully as possible and not cut. In particular, all formwork must be treated with release agent before concreting. Formwork beams must not be truncated under any circumstances. The greatest possible care must be taken when compressing concrete poured into the formwork, in order not to damage it.
- 9.5. All rented goods must be returned in a clean condition when the rental period ends. Otherwise the costs of subsequent cleaning will be invoiced to the Client. The Client is responsible for return carriage, which must take place at its own expense. The rented goods must be prepared for unloading so that they can be lifted easily by crane. A separate charge will be imposed for any work necessary for unloading, such as rearrangement, etc.
- 9.6. The rental charge for formwork does not include consumables (spacing tubes, plugs, tapers, release agent, etc.). When handling the elements, care must be taken that their wooden parts are not scratched (e.g. by sharp edges and corners of other elements). Particular care must be taken not to damage elements when cleaning them. Following use, the formwork must be placed on the pallets and in the crates provided. Small parts must be boxed. A separate charge will be made for any cleaning, sorting and repair work which may be necessary. Lost small parts must be replaced.
- 9.7. The rented goods will be made available for the agreed term. Should the Client be in arrears of payment of the rent or should it handle the rented goods carelessly or contrary to instructions, TOBLER will be entitled to cancel the rental agreement immediately and repossess the rented goods. In this case, the costs of return carriage will be invoiced to the Client separately. The Client will also be obliged to pay compensation for premature termination of the rental agreement. In particular, TOBLER must be placed in the position which it would have enjoyed had the rental agreement remained in force for the entire anticipated rental term. In this case, TOBLER will not be obliged to ensure the re-rental of the goods throughout the remainder of the anticipated rental term.
- 9.8. Should no firm rental agreement term be anticipated or should the Client continue to use the rented goods beyond the contractual term originally intended, both parties will be entitled to terminate the rental agreement at any time, subject to observance of a fourteen-day period of notice.

## 10. Static calculations

- 10.1. The prices do not include static calculations. They will be invoiced additionally at the request of and in accordance with the requirements of the Client.

## 11. Prohibition of assignment and offsetting

- 11.1. The Client is not entitled to offset claims by TOBLER against its own claims unless TOBLER has expressly agreed to offsetting in writing.
- 11.2. The Client is prohibited from assigning claims arising out of the contractual relationship with TOBLER to third parties.

## 12. Preclusion of further liability

- 12.1. Any claims by the Client, with the exception of those expressly identified in these terms and conditions, on any legal basis whatsoever, particularly any claims for compensation, reduction or cancellation of the contract which are not expressly stipulated, are precluded. Under no circumstances will the Client be entitled to claim compensation for damage which does not affect the delivered item itself, such as loss of production, loss of use, orders, profit or other direct or indirect losses.

## 13. Amendments and liability

- 13.1. TOBLER reserves the right to amend these T&Cs at any time. The Client will be notified of amendments by circular letter or in another suitable way. They will be deemed to have been accepted unless a written objection is received within one month.

## 14. Copyright

- 14.1. TOBLER retains unrestricted title to drafts, drawings, etc. which it has prepared. They may not be copied or rendered accessible to third parties without TOBLER'S permission.
- 14.2. The imitation of goods, even if for exclusive personal use, will be subject to prosecution under criminal law.
15. Applicable law and court of jurisdiction
- 15.1. All legal relationships between the Client and TOBLER are governed by Swiss law, to the exclusion of the UN Convention on Contracts for the International Sale of Goods.
- 15.2. The sole place of jurisdiction for any proceedings and the place of recovery, but only for Clients with a foreign domicile (Article 50(2) of the Swiss Debt Recovery and Bankruptcy Act), is the domicile of TOBLER in Rheineck. However, TOBLER is entitled to pursue the Client before the responsible court at the latter's domicile or place of residence, or before any other responsible court.



**Tobler**<sup>®</sup>  
Scaffolding. Formwork.

Langenhagstrasse 48-52  
CH-9424 Rheineck  
Tel. +41 71 886 06 06

Fax +41 71 886 06 16  
info@tobler-ag.com  
www.tobler-ag.com